



Installation and operation manual

Audio doorphone set ATIN

OR-DOM-RD-937

OR-DOM-RD-938



STOP!

Be sure to read the **operating manual** before installation!
Damage resulting from incorrect installation
ARE NOT SUBJECT TO WARRANTY REPAIRS!



TABLE OF CONTENTS

1. SAFETY INSTRUCTIONS	3
2. PRODUCT DESCRIPTION	3
3. INTENDED USE	4
4. TECHNICAL DATA	4
5. SET CONSTRUCTION	5
6. INSTALLATION	5
OUTDOOR UNIT INSTALLATION	5
INDOOR UNIT INSTALLATION	6
7. WIRING DIAGRAM	7
8. SET OPERATION	8
INDOOR UNIT OPERATION	8
OUTDOOR UNIT OPERATION	8
9. CLEANING AND MAINTENANCE	9
10. AFTER-SALES SERVICE	9
11. SAFETY-RELATED COMMUNICATION CHANNELS	9
12. ADDITIONAL INFORMATION	9



(EN) Installation and operation
manual
(DE) Bedienungs- und
Montageanleitung

OR-DOM-RD-937



(EN) Installation and operation
manual
(DE) Bedienungs- und
Montageanleitung

OR-DOM-RD-938



1. SAFETY INSTRUCTIONS

Warnings and precautions for the safe use of the product:







1. Before using the device, read this user manual carefully and keep it for future reference.
2. Self-repairs or modifications will void the warranty.
3. The device may only be used as intended. Any other use is considered unsafe.
4. The manufacturer is not liable for damages resulting from improper installation or use of the device.
5. The device should be installed by an experienced person with the appropriate qualifications.
6. Perform all tasks with the power supply disconnected.
7. Do not immerse the device in water or other liquids.
8. Do not operate the device if the housing is damaged.
9. Do not touch the internal components of the operating device directly or indirectly – risk of electric shock and/or burns.
10. Do not cover the device. Ensure free airflow.
11. Avoid striking, shaking, or colliding other objects with the device, as this may cause damage to the internal components of the unit.

Disposal instructions

 Each household is a user of electrical and electronic equipment, and hence a potential producer of hazardous waste for humans and the environment, due to the presence of hazardous substances, mixtures and components in the equipment. On the other hand, used equipment is valuable material from which we can recover raw materials such as copper, tin, glass, iron and others. The WEEE sign placed on the equipment, packaging or documents attached to it indicates the need for selective collection of waste electrical and electronic equipment. Products so marked, under penalty of fine, cannot be thrown into ordinary garbage along with other waste. The marking means at the same time that the equipment was placed on the market after August 13, 2005. It is the responsibility of the user to hand the used equipment to a designated collection point for proper processing. Used equipment can also be handed over to the seller, if one buys a new product in an amount not greater than the new purchased equipment of the same type. Information on the available collection system of waste electrical equipment can be found in the information desk of the store and in the municipal office or district office. Proper handling of used equipment prevents negative consequences for the environment and human health!

10/2025

Applied markings

1.	2.	3.
		
4.	5.	6.
		

1. Product compliant with EU directives.
2. Manufacturer..
3. Disposal of used electrical equipment..
4. Additional documentation and/or user manual.
5. Keep tidy.
6. Recycling code (corrugated fiberboard (cardboard)).

2. PRODUCT DESCRIPTION

The Atin audio doorphone is a modern solution for single- and multi-family homes. Its simple two-wire installation allows for quick setup, while the aluminum outdoor unit with a high protection rating ensures durability and resistance to weather conditions. The slim design makes it suitable even for narrow posts. The device supports 125kHz RFID cards and tags, offers 16 ringtones, adjustable volume, and a mute mode. Gate and wicket control can be conveniently managed from the indoor unit, without the need for an additional power supply for the electric strike.

The set includes:

OR-DOM-RD-937: indoor unit, power supply, mounting bracket for indoor unit, outdoor unit, outdoor unit rainshield, screws, wall plugs, 2-pin connector, RFID tag 125kHz (2 pcs. administrator and 5 pcs. user)

OR-DOM-RD-938: indoor unit (2 pcs.), power supply (2 pcs.), mounting bracket for indoor unit (2 pcs.), outdoor unit, outdoor unit rainshield, screws, wall plugs, 2-pin connector, RFID tag 125kHz (2 pcs. administrator and 5 pcs. user).



3. INTENDED USE

The set is designed for installation in single-family buildings. The outdoor unit is suitable for surface-mounted, outdoor installation. The indoor unit designed for surface mounting in enclosed spaces. The set enables remote communication, access control, and operation of the electric strike and gate, making it ideal for houses, apartments, or other properties with access control requirements.

4. TECHNICAL DATA

TYPE OF DEVICE:	single-family - OR-DOM-RD-937 multi-family - OR-DOM-RD-938
INSTALLATION METHOD:	2-wire
COMMUNICATION SYSTEM:	wired

INDOOR UNIT

FUNCTIONS:	call, door and gate control, volume control, mute mode
NUMBER OF RINGTONES:	16
VOLUME CONTROL:	yes
SUPPLY VOLTAGE:	15V DC 1A
POWER CONSUMPTION:	standby <1W; work <5W
ELECTRICAL STRIKE CONTROL:	yes (12V DC max. 350mA - powered from monitor)
GATE CONTROL:	yes (dry contact)
WORKING TEMPERATURE:	-10°C ~ +50°C
INSTALLATION:	surface-mounted
MATERIAL:	plastic
DIMENSIONS:	201 x 62 x 54mm
NET WEIGHT:	0.275kg

OUTDOOR UNIT

RFID READER:	119-128.6kHz RFID-tags/cards (max. 100 users)
ELECTRICAL STRIKE CONTROL:	yes, 12V DC max. 350mA
INGRESS PROTECTION:	IPX5
POWER SUPPLY:	12V DC from indoor unit
POWER CONSUMPTION:	standby <1W, work <5W
WORKING TEMPERATURE:	-20°C ~ +50°C
INSTALLATION:	surface-mounted
MATERIAL:	aluminium
DIMENSIONS:	149 x 62 x 41mm
NET WEIGHT:	0.278kg



5. SET CONSTRUCTION

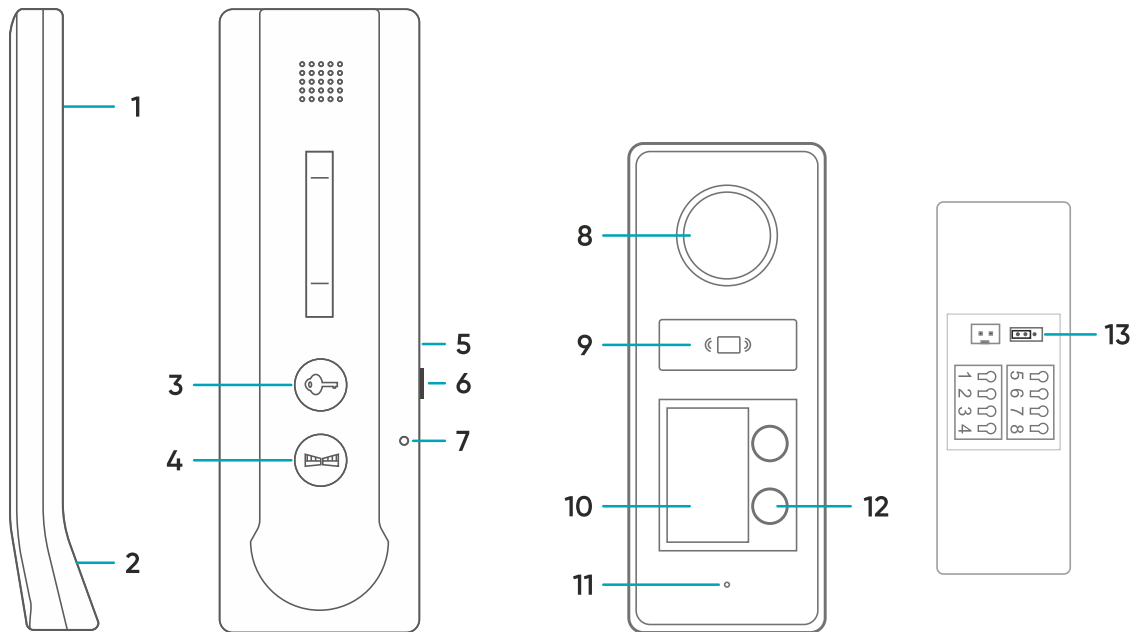

fig. 1 Indoor and outdoor unit construction.

INDOOR UNIT

- 1. Loudspeaker
- 2. Microphone
- 3. Open the door/wicket
- 4. Open the gate
- 5. Melody selection
- 6. Volume adjustment
- 7. LED indication

OUTDOOR UNIT

- 8. Loudspeaker
- 9. RFID reader
- 10. Space for name
- 11. Microphone
- 12. Call button
- 13. Operating mode switch

6. INSTALLATION

OUTDOOR UNIT INSTALLATION

Recommended installation height of the outdoor unit is 140-170cm.

The correct location of the outdoor unit determines the comfort of working with the device. It is recommended to test the device before making mounting holes. Do not place the outdoor unit and the indoor unit in the same room as interference may occur.

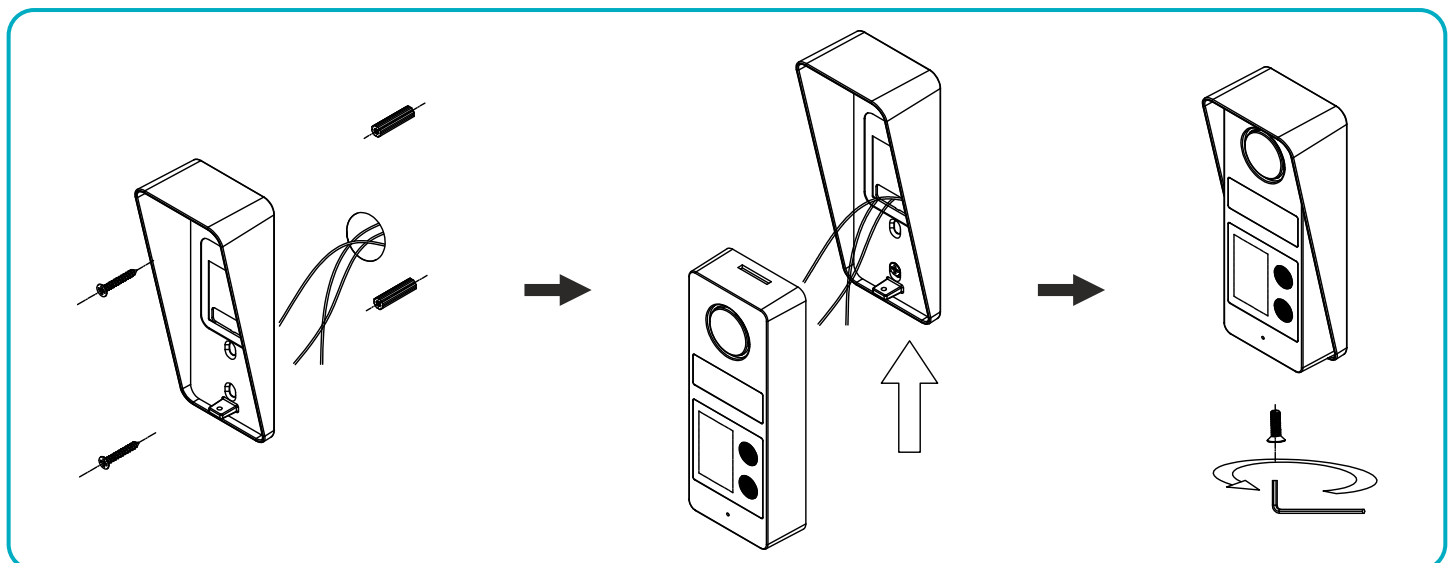

fig.2 Outdoor unit placement.



1. Select the installation location. The device should be mounted in a spot that allows convenient use.
2. Ensure that the connection cable has been routed to the selected location and that its length is sufficient for proper device installation.
3. Remove the rainshield from the outdoor unit. Use the rainshield to mark the screw hole positions.
4. Drill holes at the marked positions.
5. Insert the wall plugs (included in the set) into the drilled holes.
6. Feed the connection cable through the rainshield.
7. Using the screws included in the set, fasten the rainshield to the wall.
8. Connect the wires according to the wiring diagram.
9. Insert the outdoor unit under the rainshield.
10. Secure the assembly from the bottom using the small screw included in the set.

INDOOR UNIT INSTALLATION

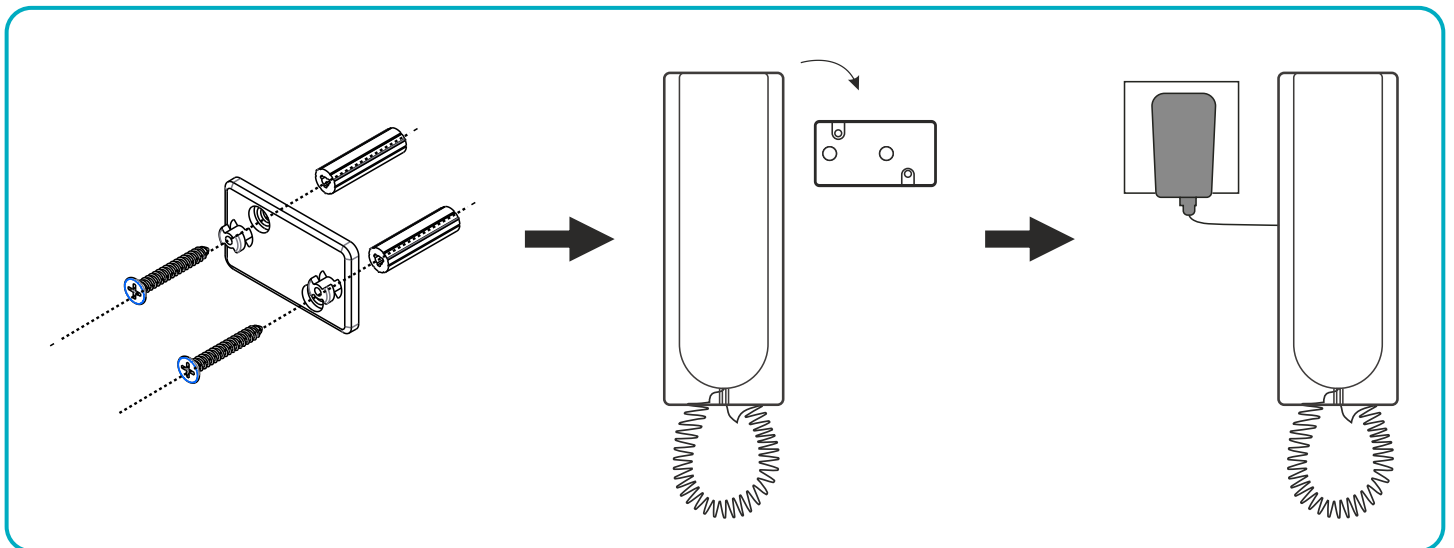

fig.3 Indoor unit installation.

1. Select the installation location. The device should be mounted at eye level for optimal use.
2. Ensure that the connection cable has been routed to the selected location and that its length is sufficient for proper device installation.
3. Mark two screw positions corresponding to the mounting holes on the mounting bracket. Use a spirit level to ensure that the indoor unit will hang evenly.
4. Drill holes at the marked positions.
5. Insert the wall plugs (included in the set) into the drilled holes.
6. Fasten the mounting bracket using the screws.
7. Connect the wires according to the wiring diagram.
8. Hang the indoor unit on the mounting bracket, aligning the holes in the rear cover. Gently pull down to ensure that the device is securely in place.
9. Connect the power supply and check that the device is functioning correctly.



7. WIRING DIAGRAM

It is forbidden to make connections to live equipment! Failure to comply with the above recommendation may result in permanent damage to the device and serious risk to health. To prevent interference, do not route "low-voltage" cables in the same conduit as high-power cables.

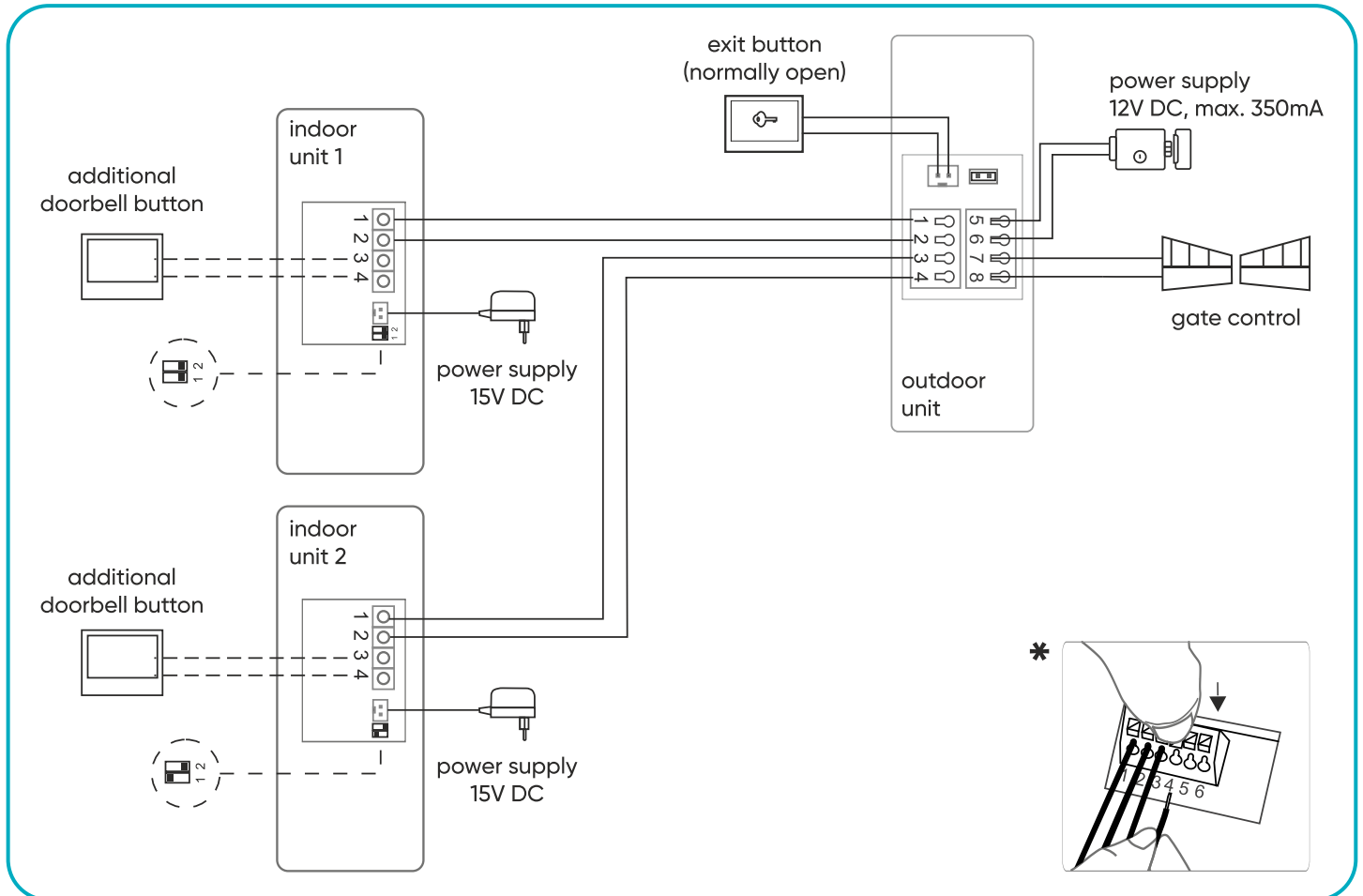

fig. 4 Wiring diagram.

The set does not include an electric door strike or gate control unit!

* Wiring connection to terminals: To connect the wires to the terminals, press the terminal release button and insert the wire into the appropriate opening. Then release the button to lock the wire in place. Finally, gently pull the wire to ensure it is properly and securely fastened.

Audio doorphone wires should not be routed within the same cable as wires from other installations, such as doorbells, alarms, telephones, etc. Any power or telecommunication cables that emit strong magnetic fields (e.g., loudspeakers, television receivers) and come into direct contact with the wires connecting the outdoor unit to the indoor unit may adversely affect the operation of the system.

While designing the wiring system, take into account the suitable cross-section of cables:
Up to 30 m - recommended cable XzTKMXpw 2 x 2 x 0.5 mm
From 30 m to 100 m - recommended cable XzTKMXpw 2 x 2 x 0.8 mm

The following can be connected to the set:
Electric strike - 12V DC, max. 350mA
Gate control - NO

The connection to the electromagnetic lock should be made with 2 x 1mm² cable. The set is compatible with any electric door strike with 12V DC supply voltage and current consumption of max. 350 mA. The total length of the installation must not exceed 100 meters. We absolutely do not recommend the use of twisted-pair cables.



8. SET OPERATION

INDOOR UNIT OPERATION

Status indicator

1. When the power supply is correctly connected, the LED indicator remains on continuously in standby mode.
2. (Multi-family set) If one indoor unit is engaged in a conversation with the outdoor unit, the LED indicator on the second indoor unit will flash until the conversation ends. Lifting the handset of the second indoor unit during the ongoing call will not interrupt the connection; instead, the active conversation will be indicated by a triple beep signal.

Opening function

1. During a conversation or after lifting the handset, press the wicket opening button – the wicket will open. The opening time is 5 seconds.
2. During a conversation or after lifting the handset, press the gate opening button – the gate will open. The opening time is 1 second.

Ringtone selection and volume control

1. In standby mode, press the melody selection button to choose one of the 16 available ringtones.
2. To adjust the ringtone volume, move the volume control switch to the desired position (high, low, mute).

Conversation

1. Press the call button on the outdoor unit to initiate a connection. The outdoor unit and the indoor unit will both play the ringtone.
2. After lifting the handset, the conversation begins, with a maximum duration of 2 minutes.
3. During the conversation, it is possible to open the wicket/gate.
4. To end the call, place the handset back on the cradle.

OUTDOOR UNIT OPERATION

Two Master tags are included in the set (green Master Add tag and red Master Delete tag) as well as five user tags. The device memory can store up to 100 users. Once this limit is exceeded, when attempting to add new users, the outdoor unit will emit a double beep, indicating that the memory is full and that additional tags cannot be registered.

Operating mode switch

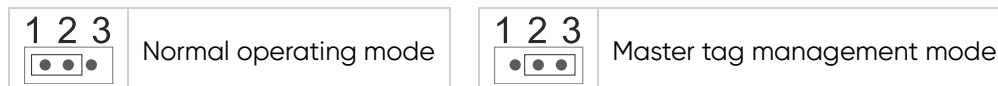

Adding Master tags

1. Turn off the power supply of the outdoor unit and set the mode switch to *Master tag management mode*.
2. Turn on the power supply of the outdoor unit. A triple beep will indicate that the system has entered *Master tag management mode*.
3. Place the first proximity tag to the RFID reader. It will be registered as the Master Add tag.
4. Place the second proximity tag to the RFID reader. It will be registered as the Master Delete tag.
5. Turn off the power supply of the outdoor unit and set the mode switch to *Normal operating mode*.
6. Turn on the power supply of the outdoor unit. The Master tags have now been registered.

Adding User Tags

1. In *Normal operating mode*, place the Master Add tag to the RFID reader.
2. Place the new user tags one by one to the RFID reader for registration.
3. Place the Master Add tag to the RFID reader again to complete the procedure.

Deleting User Tags

1. In *Normal operating mode*, place the Master Delete tag to the RFID reader.
2. Place the registered user tags one by one to the RFID reader for deletion.
3. Place the Master Delete tag to the RFID reader again to end the procedure.

Deleting All User Tags

1. In *Normal operating mode*, place the Master Delete tag to the RFID reader.
2. Place the Master Add tag to the RFID reader.
3. Place the Master Delete tag to the RFID reader again to end the procedure.



9. CLEANING AND MAINTENANCE

Clean any dirt with a soft slightly damp cloth with mild cleaning agents designed for plastic. Do not use cleaning agents based on solvents, gasoline, etc., or agents containing abrasive substances.

10. AFTER-SALES SERVICE

If, despite the care we have taken in designing and manufacturing your product, it is not working properly, please contact our technicians in the after-sales service team:

Retail Customer Advisor

Phone: +48 (32) 43 43 110 int. 109

e-mail: techniczny@orno.pl

Monday to Friday from 8:00 a.m. to 5:00 p.m.

11. SAFETY-RELATED COMMUNICATION CHANNELS

All complaints and information related to the safety of the product should be reported to the manufacturer via the website: www.orno.pl.

12. ADDITIONAL INFORMATION

In view of the fact that the technical data are subject to continuous modifications, the manufacturer reserves a right to make changes to the product characteristics and to introduce different constructional solutions without deterioration of the product parameters or functional quality. Additional information about ORNO products is available at www.orno.pl. Orno-Logistic Sp. z o.o. holds no responsibility for the results of non-compliance with the provisions of the present Manual. Orno Logistic Sp. z o.o. reserves the right to make changes to the Manual - the latest version of the Manual can be downloaded from support.orno.pl. Any translation/interpretation rights and copyright in relation to this Manual are reserved.

Responsible entity:

 ORNO-LOGISTIC Sp. z o.o.

ul. Rolników 437, 44-141 Gliwice, Polska

tel. (+48) 32 43 43 110, www.orno.pl