

CE

ViRONE

DIGITAL PEEPHOLE VIEWER WITH RECORDING FUNCTION

DV-2

INSTALLATION AND OPERATION MANUAL



Before using the device, read this operation manual and keep it for future use. Any repair or modification carried out by yourselves results in loss of guarantee. The manufacturer is not responsible for any damage that can result from improper device installation or operation.

In view of the fact that the technical data are subject to continuous modifications, the manufacturer reserves a right to make changes to the product characteristics and to introduce different constructional solutions without deterioration of the product parameters or functional quality.

The latest version of the Manual can be downloaded from support.virone.pl. Any translation/interpretation rights and copyright in relation to this Manual are reserved.



Each household is a user of electrical and electronic equipment, and hence a potential producer of hazardous waste for humans and the environment, due to the presence of hazardous substances, mixtures and components in the equipment. On the other hand, used equipment is valuable material from which we can recover raw materials such as copper, tin, glass, iron and others.

The weee sign placed on the equipment, packaging or documents attached to it indicates the need for selective collection of waste electrical and electronic equipment. Products so marked, under penalty of fine, cannot be thrown into ordinary garbage along with other waste. The marking means at the same time that the equipment was placed on the market after August 13, 2005. It is the responsibility of the user to hand the used equipment to a designated collection point for proper processing. Used equipment can also be handed over to the seller, if one buys a new product in an amount not greater than the new purchased equipment of the same type. Information on the available collection system of waste electrical equipment can be found in the information desk of the store and in the municipal office or district office. Proper handling of used equipment prevents negative consequences for the environment and human health!

Components included:

- peephole camera - 1 pc.
- indoor unit - 1 pc.
- mounting bracket - 1 pc.
- mounting sleeves and fastening screw

CHARACTERISTICS AND TECHNICAL DATA

The device for viewing the visitor standing directly in front of the door replaces the traditional optical viewer.

- easy installation and operation,
- wide-angle camera in the form of a peephole,
- 1,3 megapixel camera with a ZOOM function,
- storage of video and photo files on a Micro SD card (not included),
- 32 selectable ringtones,
- discreet monitoring of the environment after pressing a button on a peephole,
- automatically switch off the screen 10 seconds after pressing the preview button.

Peephole dimensions: 111 x 83 x 28 mm

Peephole camera dimensions: 63 x 63 x 17 mm

Door thickness range: 32-60 mm or 67-105 mm

Mounting hole diameter: 14mm~22 mm

Power supply: 3 batteries 1,5V AA type (not included)

Display: 3,5" TFT, 640 x 480 pixels

Memory card: Micro SD, max 32 GB (not included)

Camera viewing angle: 110°

Language: Polish

Recording mode: photo, video

Photo format: JPG

Video format: AVI

Net weight: 0,18 kg

CAMERA CONSTRUCTION

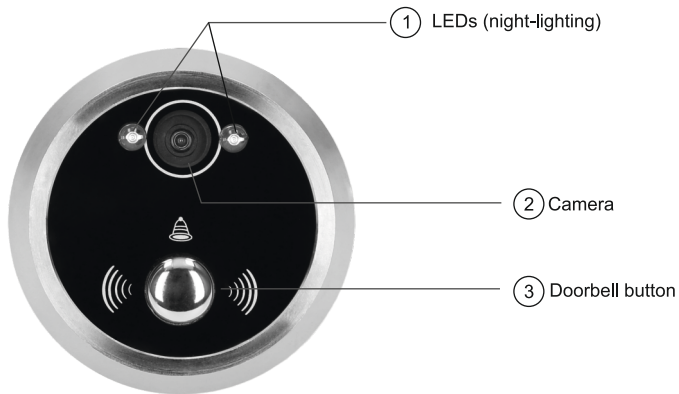

DOOR VIEWER CONSTRUCTION

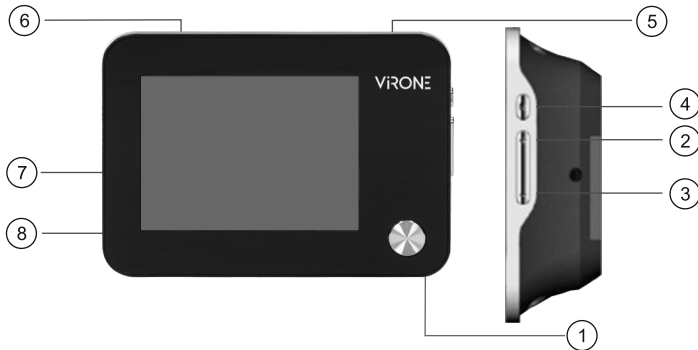

1. Monitoring (preview of the environment)
2. Button + (moving up the menu and zoom in on the image)
3. Button - (moving down the menu and zoom out of the image)
4. MENU button – settings of language, date, screen off, operation mode, preview

5. Micro SD memory card slot (no card included)
6. Loudspeaker
7. Battery compartment
8. TFT 3,5" screen

INSTALLATION

1. Insert the mounting sleeve matching the thickness of the door. The diameter of the hole should be 14mm. Insert the camera lens into the sleeve (peel off the protection on the adhesive paper on the back of the camera), taking care not to damage the ribbon cable.
2. Peel off the protection from the monitor bracket.
3. Pass the ribbon cable from the external camera through the hole in the bracket. Adjust the camera position so that the camera and LEDs are at the top and the bell button is at the bottom. Attach the external camera and the monitor bracket to the door.

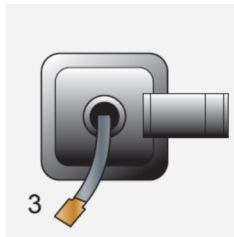

INSTALLATION

4. Insert three 1.5V type AA batteries into the indoor unit (not supplied), then connect the ribbon cable of the external camera to the indoor unit (following the arrows that must point up). Fix the indoor unit on the mounting bracket.
5. Screw the indoor unit to the mounting bracket with the screw.

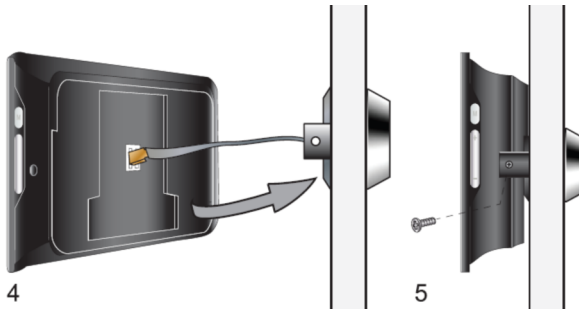

SETTINGS

Language:

Language settings

Press the „Menu” button and then the „+” or „-” button to select the „Language” function. Select the language with the „+” and „-” buttons, then confirm your choice by pressing the „Menu” button.

Date:

Date and time setting

Press the „Menu” button and then the „+” or „-” button to select the „Date” function. Set the date with the „+” and „-” buttons, then confirm your choice by pressing the „Menu” button.

Frequency:

Frequency settings

Press the „Menu” button and then the „+” or „-” button to select the „Frequency” function. Set the frequency using the „+” and „-” buttons, then confirm your choice by pressing the „Menu” button (most European countries require a 50 Hz frequency setting for electrical devices).

Deactivating preview (Auto Off CD):

Setting the preview time on the indoor monitor.

Press the „Menu” button and then the „+” or „-” button to select the „Preview Off” function. Set the preview time on the monitor (10sec/20sec/30sec) with the buttons „+” and „-”, then confirm your selection by pressing the „Menu” button

SETTINGS

Save a photo or video sequence to a memory card:

Press the „Menu” button and then the „+” or „-” button to select the „Mode” function. Select the capture mode (photo or video) with the „+” and „-” buttons, then confirm your selection by pressing the „Menu” button.

Watch:

View stored images or video sequences on the memory card.

Press the „Menu” button and then the „+” or „-” button to select the „Watch” function. Use the „+” and „-” buttons to browse the stored pictures or video sequences taken by the door viewer. Press the „Menu” button to stop viewing.

Night mode:

Switching on the IR light enables observation in the dark.

Press the „Menu” button and then the „+” or „-” button to select Night Mode. Use the „+” and „-” buttons to select whether night mode should be on or off, then confirm your choice by pressing the „Menu” button.

Switching to night mode occurs automatically when the doorbell button or monitoring button on the monitor is pressed.

SETTINGS

Doorbell mute ("do not disturb" mode):

Press the „Menu” button and then the „+” or „-” button to select the „Mute” function. Use the „+” and „-” keys to turn the doorbell signal on or off. Press the „Menu” button to confirm the selection.

Pressing the doorbell button on the external camera will not activate the ringing tone.

Doorbell settings:

Selectable ringtone and volume

Press the „Menu” button and then the „+” or „-” button to select „Ringtone settings”. Use the „+” and „-” keys to select the ringing tone. Selecting the Ringtone item allows you to select one of the 32 built-in ringtones. Pressing the "Menu" key confirms the selection.

Menu leaving:

Select the "Exit" item using the "+" and "-" buttons.. Press the „Menu” button to confirm the selection.

OPERATION OF THE DEVICE

1. When you press the doorbell button, a ringtone will sound.
2. The peephole viewer will automatically take a picture when the doorbell button is pressed and save it to the memory card. The saved images can be viewed on the indoor monitor using the „Monitoring” function or directly from a memory card on any computer.
3. Pressing the „Monitoring” button allows for discreet viewing of the environment.
4. Press the „Monitoring” button again to save the image to the memory card.
5. When the „Video” mode is selected, pressing the „Monitoring” button allows you to save the video sequence on the memory card.
6. When the image is displayed, press the "+" and "-" buttons to zoom in or out.

SAFETY:

- Do not expose the device to hot air or flames.
- Do not expose the device to water or moisture.
- To ensure proper operation of the device, do not place it near sources that may cause electromagnetic interference.
- The device is intended for home use.
- The device should be operated by adults.

Warnings for battery use:

- The batteries in the device should be replaced by an adult,
- Remove used batteries from the device immediately,
- Do not throw batteries into an open fire, as they may explode,
- Do not connect the battery terminals in any way,
- Do not combine new batteries with used ones,
- Do not combine alkaline (disposable) batteries with lithium batteries or other rechargeable batteries,
- Do not use rechargeable batteries,
- Batteries should be installed in the device with due care, according to the instructions and polarization markings on the device housing,
- Remove the batteries from the device when not using it for a long time,
- Do not dispose of used batteries with other waste.

10/2021

PRODUCER

ORNO-LOGISTIC Sp. z o.o.

ul. Rolników 437, 44-141 Gliwice, tel. 32 43 43 110, www.virone.pl