

VIRONE

INSTALLATION AND OPERATION MANUAL
VIDEO DOORPHONE MONITOR
VDP-66PMV/B



INTRODUCTION

Please read this manual carefully before connecting and using the device. In case of any problems with understanding its content, please contact your seller of the device. Self-assembly and start-up of the device is possible provided that the installer has basic knowledge of electrical engineering and uses appropriate tools. Nevertheless, it is recommended that the device is installed by qualified personnel.

The manufacturer is not responsible for any damage that can result from improper device installation or operation. Any repair or modification carried out by yourselves results in loss of guarantee.

Due to the fact that the technical data is subject to continuous modifications, the Manufacturer reserves the right to make changes in design, use, etc. resulting from the continuous development of the offered solutions, aimed at improving the functionality of the product. In particular, this applies to all types of external applications, software, etc. The current operating manuals are available at support.virone.pl. Orno-Logistic Sp. z o.o. holds no responsibility for the results of non-compliance with the provisions of the present manual.

Any translation/interpretation rights and copyright in relation to this Manual are reserved.

1. Disconnect the power supply before performing any activities.
2. Do not immerse the product in water or other liquids.
3. Do not operate the device with damaged housing.
4. Do not open or repair the device yourself.
5. Do not use the device contrary to its dedication.
6. Do not install the monitor near equipment that emits a strong magnetic field such as television, loudspeakers.
7. Do not install the monitor in a place exposed to high humidity, vibration, shock or strong sunlight.
8. Do not touch directly or indirectly the internal parts of the running appliance - risk of shock and/or burns.
9. Ensure free airflow.

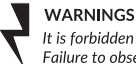

WARNINGS

It is forbidden to make connections to live equipment!

Failure to observe the above may result in permanent damage to the device.

Each household is a user of electrical and electronic equipment, and hence a potential producer of hazardous waste for humans and the environment, due to the presence of hazardous substances, mixtures and components in the equipment. On the other hand, used equipment is valuable material from which we can recover raw materials such as copper, tin, glass, iron and others. The weee sign placed on the equipment, packaging or documents attached to it indicates the need for selective collection of waste electrical and electronic equipment. Products so marked, under penalty of fine, cannot be thrown into ordinary garbage along with other waste.

The marking means at the same time that the equipment was placed on the market after August 13, 2005. It is the responsibility of the user to hand the used equipment to a designated collection point for proper processing. Used equipment can also be handed over to the seller, if one buys a new product in an amount not greater than the new purchased equipment of the same type. Information on the available collection system of waste electrical equipment can be found in the information desk of the store and in the municipal office or district office. Proper handling of used equipment prevents negative consequences for the environment and human health!



07/2022

TECHNICAL DATA

Device type:	1080p with integrated WiFi
Monitor:	10" TFT LCD
Resolution :	1024x600
Standard:	PAL
Connection type :	wired/WiFi
Wireless communication :	2.4GHz Wi -Fi 802.11b/g/n TUYA Smart App
Power consumption :	8W (working), 3W (standby)
Power supply :	15V DC, 2A
Working temperature :	0°C ~+50°C
Mounting type :	surface -mounted
Max. capacity MicroSD card:	2GB ~ 128GB, min. 10 class (recording/reading speed ≥ 10MB/s)
Video input signal:	CVBS,CVI,TVI,AHD,1080P
Motion sensor:	yes
System:	supports 6 indoor monitors + 2 outdoor panels + 2 CCTV cameras
Functions :	door and gate opening, monitoring, intercom, call transfer, video recording, mute
Additional functions :	digital frame, mp3, mp4, clock & answering machine, background music , door and gate operation
Monitor dimensions :	259x175x24mm
Monitor net weight :	0,80kg

INDOOR MONITOR SPECIFICATION

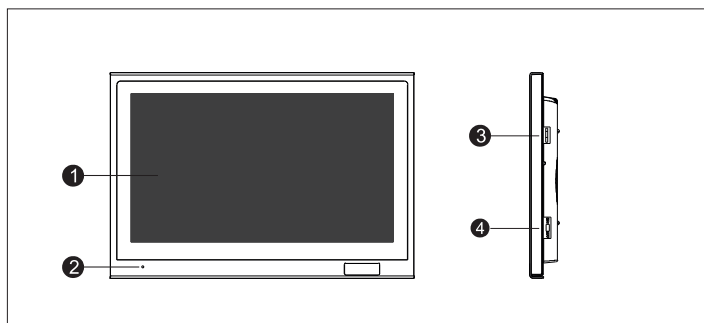

No.	Name	Description
1	TFT display	View of a person outside
2	Microphone	Transmits sounds to the outdoor panel
3	MicroSD card slot	Insert a card to save movies and images
4	ON/OFF switch button	Turning the monitor on and off

WIRING SCHEME

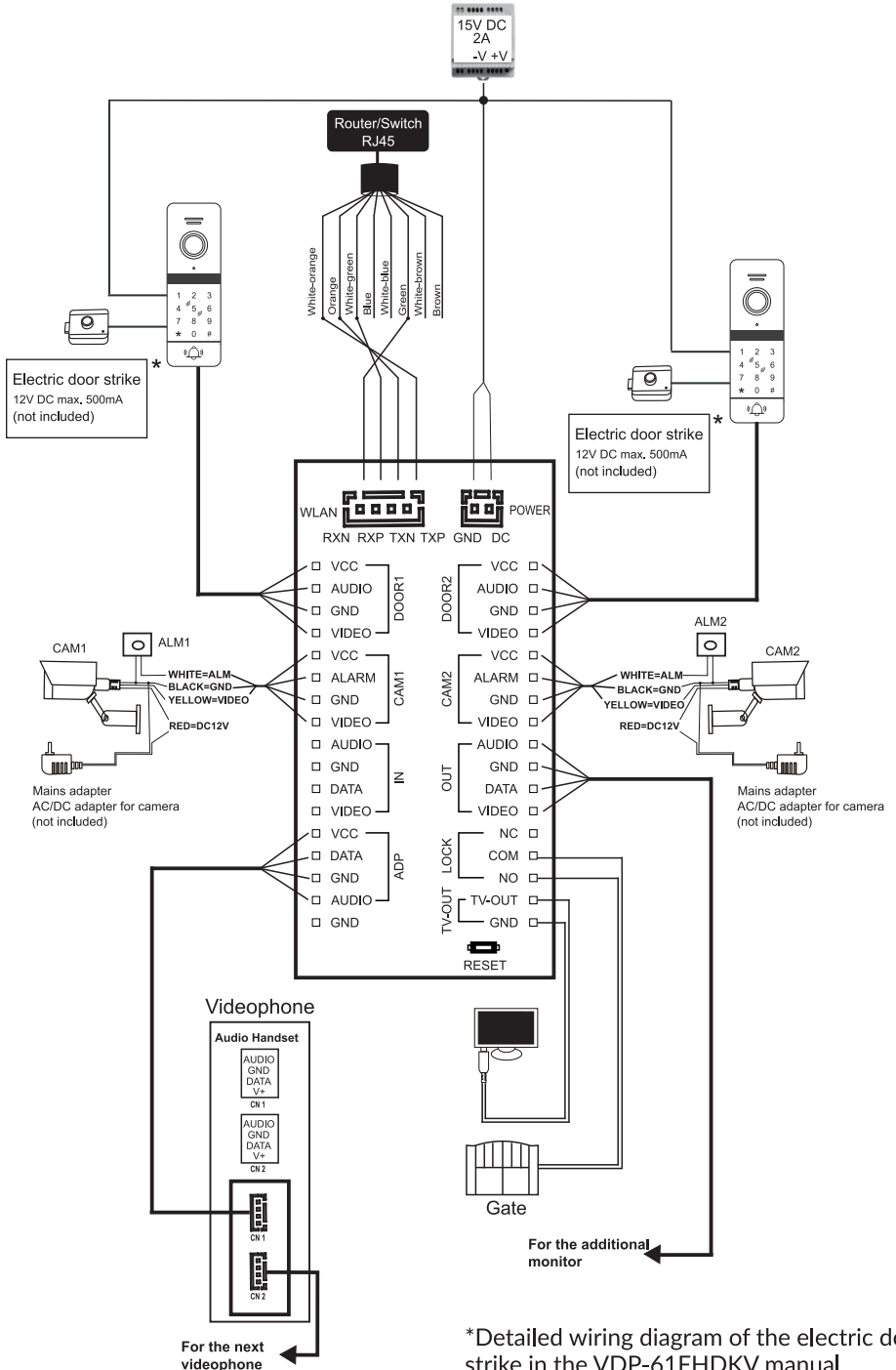

*Detailed wiring diagram of the electric door strike in the VDP-61FHDKV manual

i If the network cable plug uses a 568B conductor sequence, use the following wiring method:

1. TXP plug of RJ45 connector <-> orange cable <-> white-orange colour of network cable
2. TXN connector RJ45 <-> black cable <-> orange colour of network cable
3. RJ45 connector RXP plug <-> brown cable <-> White-green colour of network cable
4. RJ45 connector RXN <-> red cable <-> green colour of network cable

i If the network cable plug uses a 568A conductor sequence, use the following wiring method:

1. TXP plug of RJ45 connector <-> orange cable <-> white-green colour of network cable
2. TXN plug on RJ45 connector <-> black cable <-> green colour of network cable
3. RJ45 connector RXP plug <-> brown cable <-> White-orange colour of network cable
4. RJ45 connector RXN <-> red cable <-> orange colour of network cable

INSTALLATION

i Electric door strike/alarm/camera are not included in the set. You should purchase an electro door strike that will best suit the requirements of the set (12VDC max 500mA).

i The type of cable and its connection is shown below. (Correct operation of the device largely depends on the type of cable used).

When designing the electrical installation, it is important to consider the appropriate cable cross-section:

1. connection diagram of standard cable
- 4C: up to 30m recommended cable XzTKMX pw 3x2x0.5mm
from 30 to 100m recommended cable XzTKMX pw 3x2x0.8mm



2. Connection diagram for standard unshielded cable + coaxial cable for video (75Ohm-3):

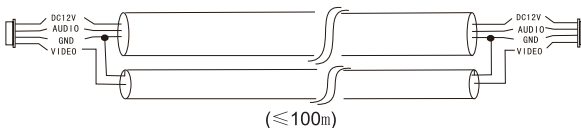

The total length of the installation must not exceed 100 metres.

Important!

It is absolutely not recommended to use twisted-pair cables.

SIMPLIFIED WIRING DIAGRAM



The first monitor must be set as the MAIN monitor. All other monitors must be set as ADDITIONAL. Menu/ Settings/ System/ Monitor address

Main=01, Additional=02-06.





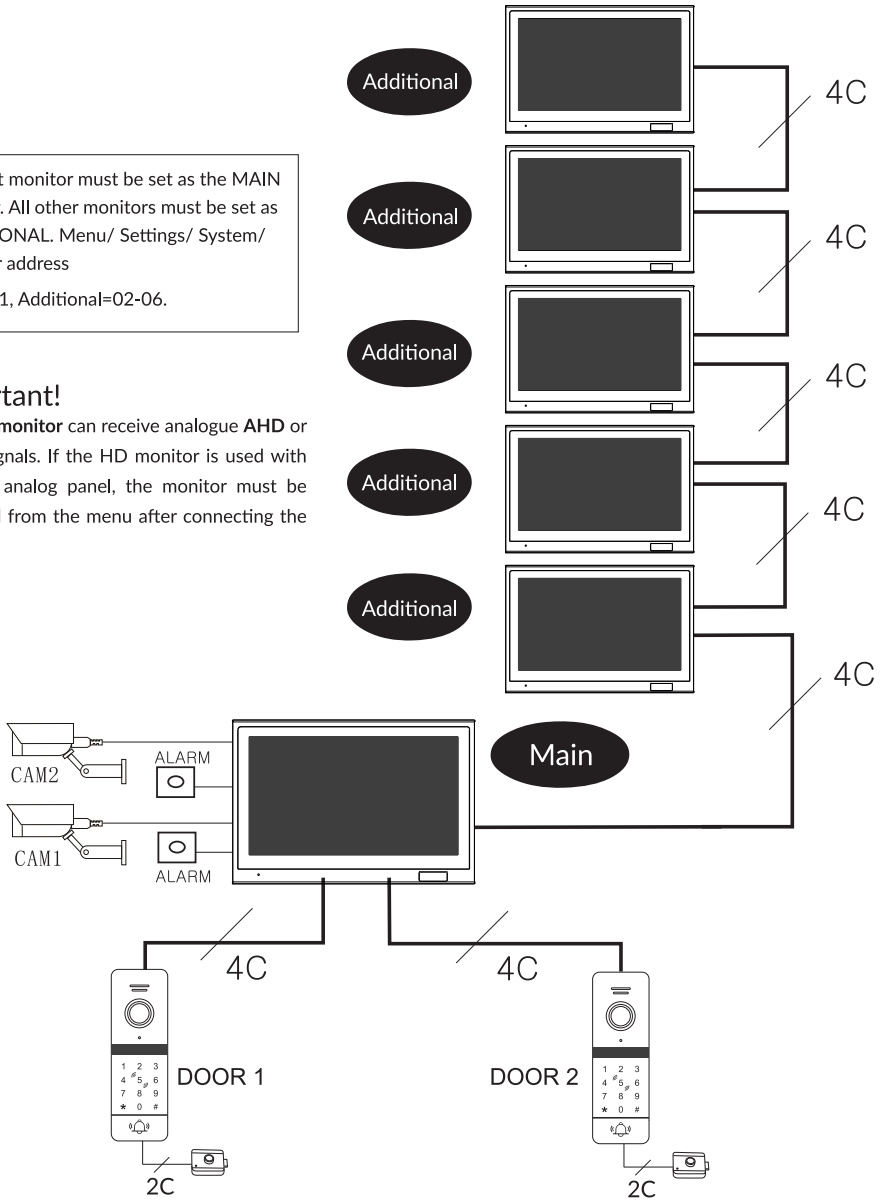







Important!

The HD monitor can receive analogue AHD or CVBS signals. If the HD monitor is used with a CVBS analog panel, the monitor must be restarted from the menu after connecting the camera.



Button functions



Monitoring		Video preview from external panel or CCTV camera
Snapshot		Saving the image currently shown on the monitor from an outdoor panel or CCTV camera
Recording		Start or stop recording from an outdoor panel or CCTV camera
Door/wicket opening		Touch the icon during a call, monitoring or after motion detection to open the door/wicket
Gate opening		Touch the icon during a call, monitoring or after motion detection to open the gate
Settings buton		Adjustment of volume, brightness, contrast and colour saturation
Call transfer buton		Touch the icon during a call  , to select the device to which you want to forward the call
Answer		<ol style="list-style-type: none"> 1. Answering the call 2. During monitoring, press the icon to start a conversation with the outdoor panel
Hang up		During a call, alarm, monitoring or motion detection, touch the icon  , to disconnect the call and return to standby mode
Return		Return to standby mode or exit

DESCRIPTION OF DEVICE OPERATION

◆ The person outside calls

Standby mode

Person outside presses call button on outdoor station 1



A ringtone is heard on the outdoor panel and the indoor monitor; the factory-set ringing time is 30 seconds.

Person outside presses call button on outdoor station 2



The camera image automatically appears on the monitor screen

On the indoor monitor, touch the TALK button



The ringtone stops

Conversation with the person in front of the outdoor panel starts



Połączenie może trwać do 120 sekund.

On the indoor monitor, touch the electric door opener button



Release of the electric door strike

On the indoor monitor, touch the call ending button



End of conversation

On the indoor monitor, touch the gate opener button



Gate opening

On the indoor monitor, touch the call ending button



End of conversation



IMPORTANT:

If a call button is pressed simultaneously on both outdoor panels, the call from the panel on which the call button was pressed first is triggered. The call from the second panel remains unanswered. When the device returns to standby mode, the call button must be pressed again to establish the call.



IMPORTANT:

The monitor will automatically go into standby mode if no one is home or if a call is not answered within 60 seconds.



1. When the electric door strike is released, the audio and video connection is maintained for 20 seconds. This function allows you to make sure that an outsider has already managed to enter.
2. When the SD card recording mode is set as video, the monitor will start recording video from the moment the call is established until the end of the call.
3. When the SD card recording mode is set as snapshot, the monitor will take a picture of the camera image the moment the call is established. You can also take pictures manually during the call.
4. During calls, a toolbar will appear on the monitor display if a call button is pressed or an alarm is triggered from a second outdoor panel.
5. When the SD card recording mode is set as video and the answering machine function is set, if a call is not answered within 30 seconds, the outdoor panel will ask the guest to leave a message. The default time for leaving a message is 30 seconds, after which time the monitor will return to standby mode.
6. All work performed on the monitor will be interrupted in the event of an incoming call from the outdoor panel.

CALL TRANSFER TO OTHER MONITORS

The internal communication function requires the connection of at least two internal monitors and one outdoor panel.

The outdoor panel sends a signal to the indoor monitor and waits for connection



Touch the button  to activate the transfer function to the device of your choice.

▼ You will hear the ringtone on the selected secondary monitor

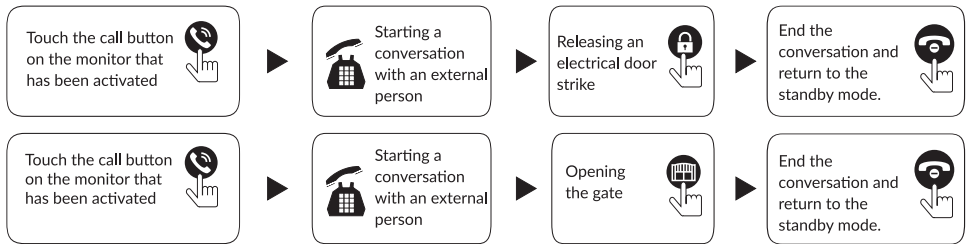

IMPORTANT:

When the call is redirected to another monitor, the first monitor will return to standby. The monitor taking the call will ring and display the picture.

CONVERSATION BETWEEN MONITORS

Internal connection requires at least two monitors.

Standby mode

Touch and hold the button 



Select the monitor  you wish to connect to 

▼ The ringtone on the selected secondary monitor will activate

Touch the talk button on this additional monitor 



IMPORTANT:

In intercom mode it is not possible to change the picture settings or adjust the call volume.

MONITORING

Select the monitoring icon in the main menu on the monitor screen to display the camera image.

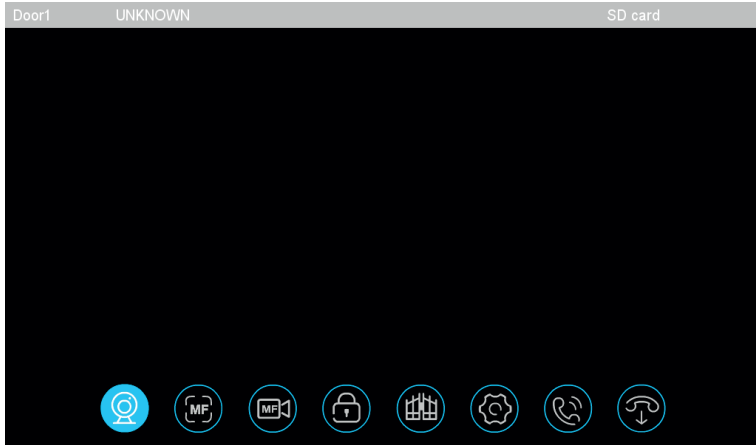

1. The monitoring time from the outdoor panel is 1 minute and from the camera 5 minutes. After the monitoring time has elapsed, the device returns to the standby state.
2. When monitoring from an outdoor panel, the device also records sound, which is played back on the monitor.
3. While monitoring from an outdoor panel, press the Answer button to talk to the person outside; the Open Door/Wicket button to open the electric door strike, the Snapshot button to save the current camera image or the Record button to record a video file. By entering the settings you can adjust the call volume, screen brightness, contrast or colour saturation.
4. Press the hang up button to end monitoring or the call and return to the standby mode.

- i** 1. If 2 (or more) monitors are connected, the same camera image can be displayed on both monitors at the same time.
- i** 2. If the call button on the outdoor panel is pressed during monitoring, the monitoring is immediately interrupted and the monitor enters talk mode.
- i** 3. During monitoring, snapshots and recordings are not taken automatically. They must be done manually by pressing the appropriate icons on the display.

MOTION DETECTION

1. In standby mode, touch the screen, then select Settings/Door setting/Camera setting /select device / in the "Motion detection" field, you can set On or Off.
2. In standby mode, touch the screen, then select Settings/System setting/Motion Detection Preview to enable motion detection preview.
3. When motion detection is activated, the device automatically transmits the image from the camera, which is immediately displayed on the monitor (if motion detection preview has been activated). If the motion detection preview is switched off, the device makes a recording which the user can later play back from the recording history.

- i** 1. The monitor will not take a picture or record when motion is detected without an SD memory card installed.
- i** 2. One monitor supports one motion detection channel.
- i** 3. The motion detection time can be adjusted accordingly, once the detection is over the monitor returns to the standby mode.

STANDBY MODE

In standby mode the monitor can display a clock or a photo on the screen (digital frame function).

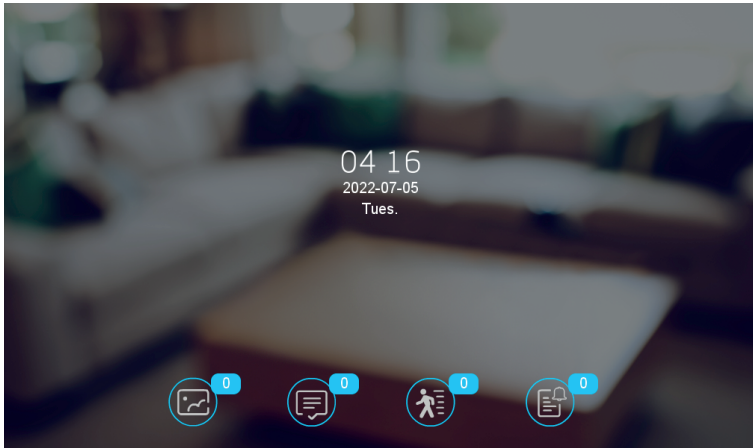

1. Clock/date mode

The screen displays the current time (hour, minute) and date (day, month, year) as well as shortcuts: photos taken after missed calls, recorded messages, detected motion and alarm records.

- the monitor goes into standby mode after 60 seconds without any action,
- in clock display mode, the screen goes blank after 60 seconds without any action,
- touch the monitor screen to display the clock (the digital frame is then turned off)
- if there are pictures taken after missed calls, recorded messages, detected motion detection or stored alarms, their number will be displayed next to the corresponding icon on the screen.

2. Digital photo frame mode

Photos stored on the SD card are displayed on the screen in standby mode.



1. When an SD card is installed in the monitor, a "Digital frame" folder is automatically created. Only pictures saved in this folder can be displayed in digital frame mode.
2. As soon as motion is detected in the detection area, the picture will be blanked out.

MAIN MENU

In standby mode, touch the screen to display the main menus: Intercom, Setting, Monitor, Media, Event, At Home, Lock and Standby. To return to standby mode, press the arrow icon or Standby.

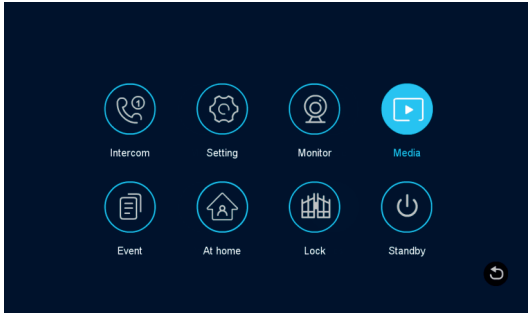

1. Intercom

The interface displays 6 icons. The first 5 are the remaining monitors (additional), the user can select one of them to communicate with the selected monitor. To call all, remaining monitors, press the last, sixth icon. The user can receive calls from any additional monitor.



2. Setting

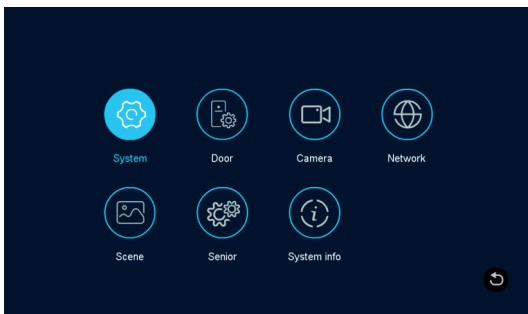

2.1. System setting

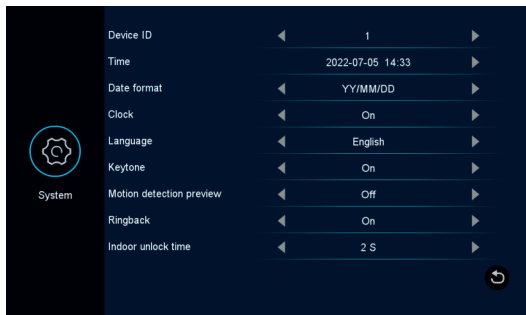

Device ID - The device ID is a number in the range 1-6, 1 is the main monitor and 2-6 are secondary monitors. The system supports a maximum of 6 monitors.

Time - 24-hour time format.

Date format - choose from 3 options: YY-MM-DD/MM-DD-YY/DD-MM-YY.

Clock - enable the clock mode during standby. When the clock is off the screen is blanked out during standby.

Language - 13 menu languages to choose from: Polish, French, Italian, Ukrainian, Arabic, Hebrew, Lithuanian, Dutch, German, Spanish, Czech, English and Russian.

Keytone - enable or disable the sound when performing actions on the monitor screen.

Motion detection preview - when motion detection preview is enabled, the camera image is displayed on the monitor immediately after motion is detected in the detection area. If motion detection preview is switched off, the device makes a recording which the user can later play back from the recording history.

Ringback - enable or disable the call signal from the outdoor station.

Indoor unlock time - the gate open time can be adjusted between 1 and 10 seconds. The factory setting is 2 seconds.

2.2. Door settings



Parameters of the outdoor panel 1 and 2 are displayed separately.

Status - indicates the operation status of the outdoor panel (on or off). The status of outdoor panel 1 is on, without possibility of change.

Unlock time - the electric door strike opening time can be adjusted in the range of 1-10 seconds. The factory setting is 2 seconds.

Record mode - 2 modes to choose from: photo or video. Video means that when the call button on the panel is pressed, the monitor will automatically start recording video and will only stop when the call is ended or the user presses the end call button on the monitor screen. Photo mode means that when the call button on the panel is pressed, the monitor will automatically take a picture of the camera image. The user can take additional pictures during the call by pressing the screenshot button on the monitor.

Motion detection - enable or disable motion detection.

Motion detection sensibility - selectable low/medium/high sensitivity of the motion detector.

Motion detection duration - The motion detection time is adjustable from 10-300 seconds. The factory setting is 20 seconds.

Message - enable or disable the function of leaving a message when the user is not at home or in case of a missed call. The factory setting is off.

Message time - the length of the recorded message can be set to one of three options: 30, 60 or 120 seconds. The factory setting is 30 seconds.

Signal mode - choice of 3 modes: Auto, PAL and NTSC. The Auto setting allows the monitor to automatically detect the outdoor panel standard.

Signal type - 7 video signal types: CVBS, AHD720, AHD1080, TVI720, TVI1080, CVI720, CVI1080. When the video signal system is set to PAL or NTSC, there are seven video signal types to choose from. When the video signal system is set to AUTO, the signal type is automatically set to Auto.

Ring setting - the user can adjust the duration of the melody (ringing), the type of ringing, select the appropriate melody and adjust the volume. The ringing tone settings can be adjusted to selected hours.



Ring time - the duration of the ringing tone (from the moment the call button is pressed until the end of the melody) is adjustable between 5 and 45 seconds. The factory setting is 30 seconds.

Ring mode - the user can choose a standard ringtone (selected from the available ringtones on the device) or a user-defined ringtone (any ringtone uploaded by the user to the SD card in the "Ring" folder).

Ring select - if a standard ringtone is selected the user has a choice of 12 melodies on the device, the factory setting is melody 1.

Ring volume - 10-step volume adjustment. The factory volume setting is 7.

2.3. Camera setting

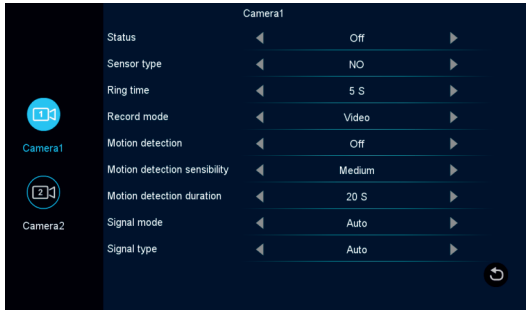

Status - indicates the on/off status of the channel (camera).

Sensor type - sensor signal type (description below), which means that when an alarm is triggered, it activates the corresponding channel to initiate an alarm log or take a snapshot.

a) **NO (Normally open)** - means that in normal operation, the sensor is maintained in a continuous low voltage state. If the output voltage changes from low to high, the alarm will sound.

b) **NC (Normally closed)** - means that in normal operation, the sensor is maintained in a continuous high voltage state. If the voltage at the output changes from high to low, the alarm will sound.

c) **Off** - if you are not using an external sensor with an alarm.

Alarm time - the alarm activation time from Camera 1 or Camera2 can be set between 1 and 20 seconds. The factory setting is 5 seconds.

Alarm record mode - 2 modes to choose from: photo or video. Video means that when an alarm is triggered, the monitor will automatically start recording a video and stop according to the set alarm duration or when the user presses the end call button on the monitor screen. Photo mode means that when an alarm is triggered, the monitor will automatically take a picture of the camera image. The user can take additional pictures during the alarm by pressing the snapshot button on the monitor.

Motion detection - indicates whether the function of detecting and recording when an object moves in front of the unit is enabled/disabled.

Motion detection sensibility - the motion detector sensitivity setting is selectable low/medium/high sensitivity.

Motion detection duration - the motion detection time is adjustable from 10-300 seconds. The factory default setting is 20 seconds.

Signal mode - divided into 3 modules: Auto, PAL and NTSC. The Auto setting allows the monitor to automatically detect the outdoor panel standard.

Signal type - 7 video signal types: CVBS, AHD720, AHD1080, TVI720, TVI1080, CVI720, CVI1080. When the video signal system is set to PAL or NTSC, there are seven video signal types to choose from. When the video signal system is set to AUTO, the signal type is automatically set to Auto.

2.4. Network settings

WiFi network settings - the monitor connects to the network and the server. The outdoor panel connects to both the indoor monitor and the smartphone app.

APP download and registration

1. Download Tuya Smart (Google Play for Android or APP store for IOS) before you start making calls and entering new settings.

2. Open the Tuya Smart app and register an account, select the appropriate country and region.

3. Once registered, log in to the Tuya Smart app.

Important: WiFi network setting is done via the Tuya Smart app.

EZ Mode

1. On the monitor, go to Setting>Network setting>Net Pairing Mode and select EZ Mode. Press the arrow icon, the monitor will restart and start in EZ mode.

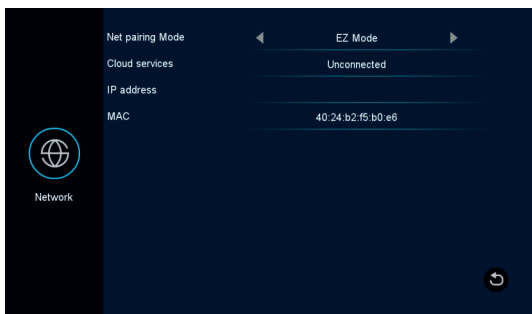

2. Log in to the application and go to the start page. Click the "+" icon in the upper right corner or Add Device.

3. Select Video Surveillance> Smart Doorbell or Smart Camera.

4. Next in the upper right corner, select Net Pairing Mode to WiFi Mode, click "Next step" and select EZ MODE.

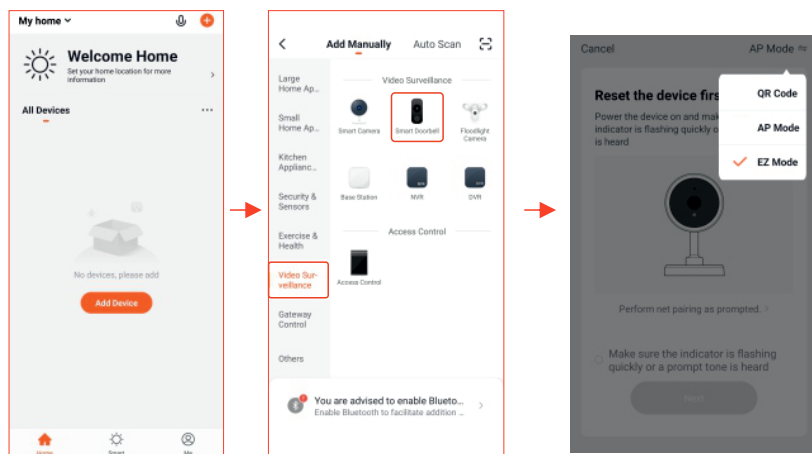

5. To connect your device to a Wi-Fi network, select your network name in the app and enter the correct password. Press the "Next" button.

6. Wait about a minute, the app screen will display "1 device(s) being added", click on "+". At the end of the process the app should display "Added successfully", click on the "Finished" button in the top right corner.

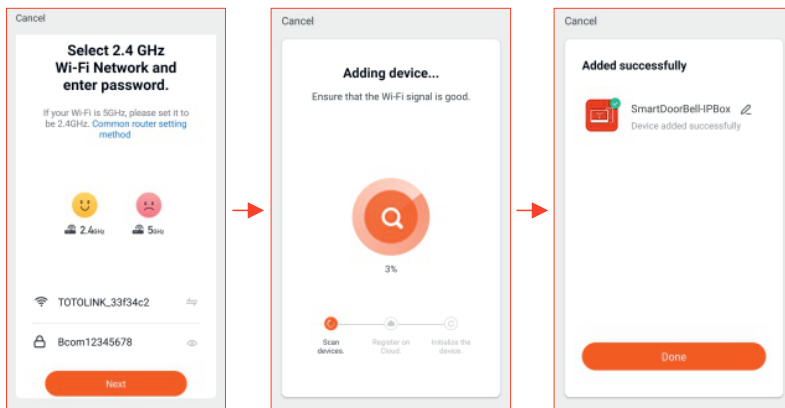

AP Mode

On the monitor, go to Setting>Network setting>Net Pairing Mode and select AP Mode. Press the arrow icon, the monitor will restart and start in AP mode. A hotspot named "SmartLife-xxxxxx" will be created.

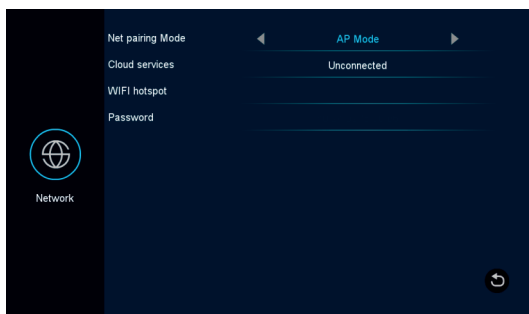

2. Log in to the application and go to the start page. Click the "+" icon in the upper right corner or Add Device.

3. Select Video Surveillance> Smart Doorbell.

4. Next in the upper right corner, select Net Pairing Mode to WiFi Mode and click "Next" and select AP MODE.

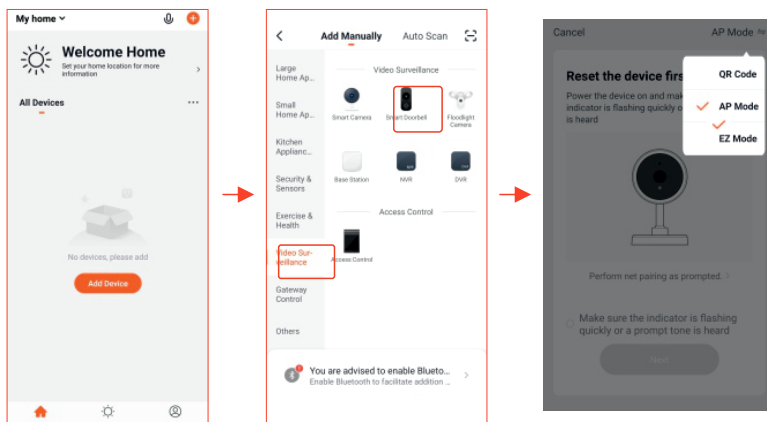

- To connect your device to a Wi-Fi network, select your network name in the app and enter the correct password. Press the "Next" button.
- Go to the WiFi settings page of your smartphone and find the hotspot name "SmartLife-xxxxx", click "Connect".
- Wait about a minute, the app screen will show Adding a device. At the end of the process the app should display "Added successfully", click the "Finished" button in the top right corner.

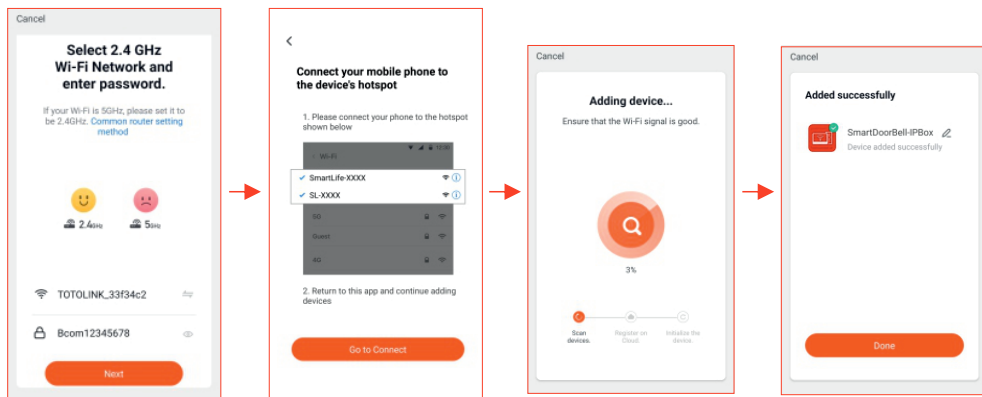

Wired mode

- Using a cat5 cable, connect the indoor monitor to the router and then connect the mobile phone to the router's WiFi network.
- On the monitor go to Setting>Network setting>Net pairing mode and select Cable. Press the arrow icon, the monitor will restart and start in cable mode.

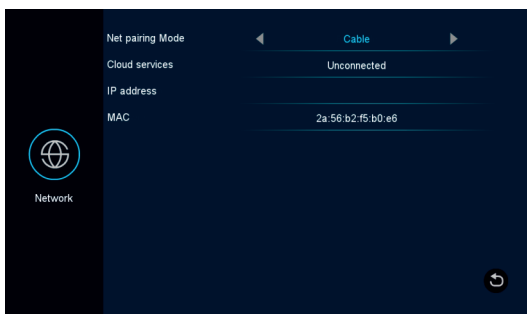

- Log in to the application and go to the start page. Click the "+" icon in the upper right corner or Add Device.
- Select Video Surveillance> Smart Doorbell or Smart Camera.

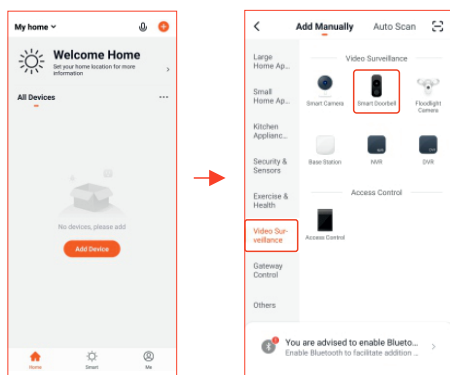

5. Then in the top right corner, select Net Pairing Mode to Cable and click "Next".

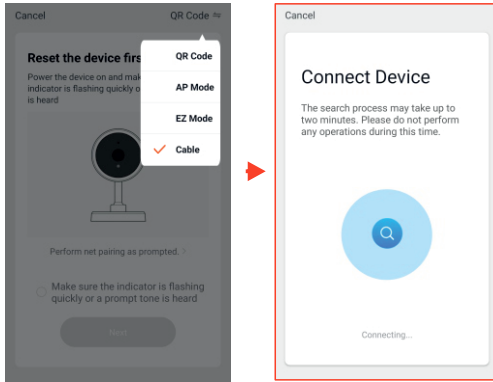

6. Select the device you wish to add.

7. Wait about a minute, the app screen will display Adding Device. At the end of the process the app should display the message "Added successfully", click the "Done" button in the top right corner.

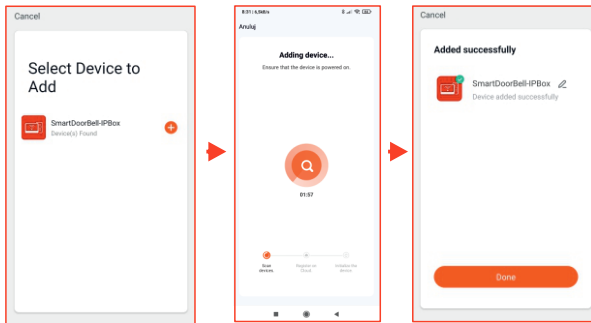

APPLICATION GUIDE

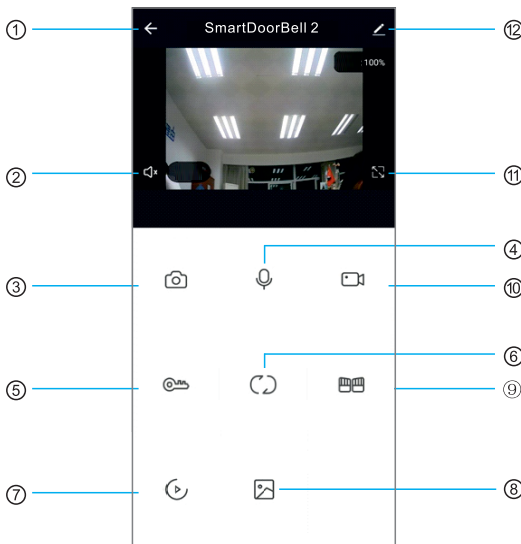

- 1) **Hang up (exit):** when the icon is pressed during a call or monitoring, the interface is exited
- 2) **Loudspeaker:** after activation, the sound coming from the outdoor panel is heard in the application
- 3) **Snapshot:** by pressing the icon during the call or during the monitoring, a picture of the image is saved (in the Android system, the pictures are saved in the photo gallery of the phone)
- 4) **Microphone:** the microphone is not active immediately after receiving a call in the application. For two-way communication it must be activated. By activating the microphone, the loudspeaker is automatically activated.
- 5) **Unlock:** Pressing the icon during a call or monitoring opens the electric door strike.
- 6) **Switch camera image:** pressing the icon during a call or monitoring will switch the image between the channels door1, door2, camera1, camera2.
- 7) **Playback:** ensure that a microSD card is installed in the monitor and that the monitor supports playback of recorded call/monitor videos.
- 8) **Photo albums:** in Android, photos are saved in the app, in IOS, photos are saved in the phone's photo gallery.
- 9) **Gate unlock:** pressing the icon during a call or monitoring activates the automatic gate control.
- 10) **Video record:** pressing the icon during a call or monitoring starts video recording.
- 11) **Full screen:** pressing the icon activates full screen mode
- 12) **Setting**

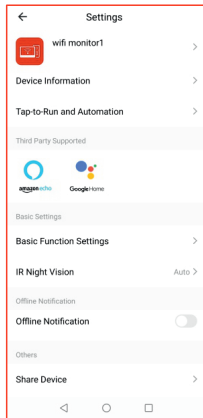

SETTINGS

- A. Device information, change of device name
- B. Application support
- C. Basic setting
- D. Storage settings
- E. On/Off notification of missing network
- F. Sharing device
- G. Remove device

Sharing a device

1. Run the app>All devices list>select the device you want to share> select the "pencil" icon in the top right corner (Settings)>Share Device>Add Sharing>enter your region/account name and press "Done".

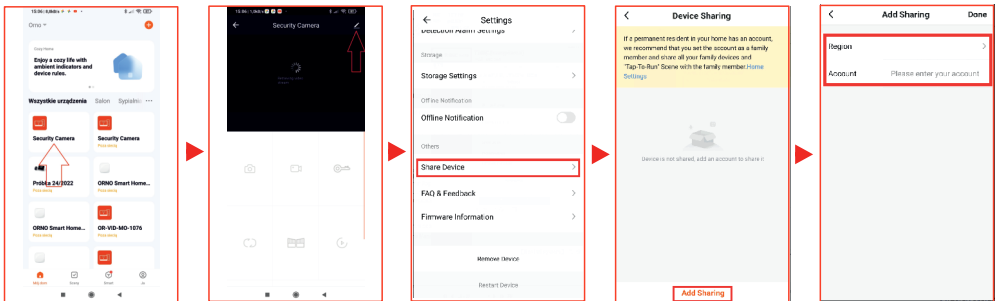

2. Run the app> All devices list>Me >Home management>Create home>Enter home name>Add member> App account> Enter the region/account name and press 'Done'.

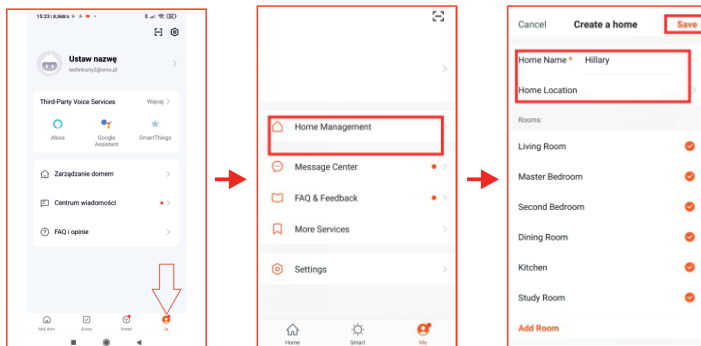

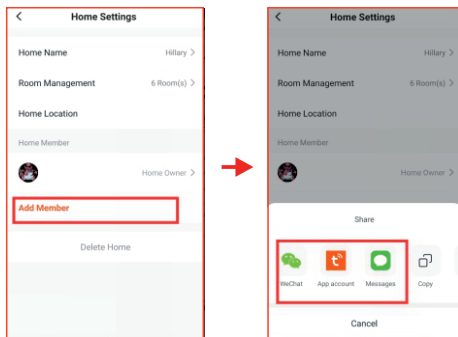

- 1. All family members receive notifications on their phone when the call button on the panel is pressed.
- 2. Admin can add and remove family members in the app under "Home management".

2.5 Scene setting



Digital photo - on/off - the picture stored on the SD card is displayed on the screen (in standby mode).

Digital photo switch time - indicates how long the image is displayed.

Background music - in standby mode, you can set the music playing in the background. The mp3 files should be saved on the SD card in the "BGMusic" folder. To have the monitor play background music, set the function to On.

Background music volume - the background music volume is adjustable from 1-10.

2.6. Senior settings

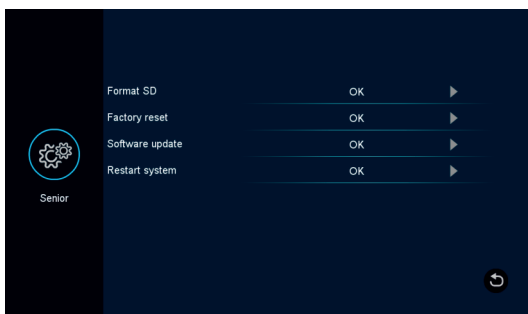

Format SD - select Ok to format the memory card. If there is no memory card, the monitor will display "no SD card".

Factory reset - select Ok to restore the device to factory settings.

Software update - select Ok to update the system, after a successful update the screen will display "Upgraded successfully" and then the monitor will restart.

Restart system - select Ok to restart the monitor.

2.7. Information



Hardware version - displays the current version of the device.

Firmware version - displays the current version of the MCU.

Software version - displays the current software version.

Release date - displays the release date of the current software version.

SD size - displays the free and total capacity of the SD card.

3. Media

The multimedia interface includes Movie, Music, Photo and Files.

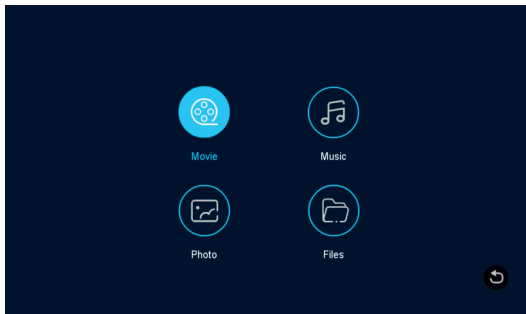

3.1. Movie

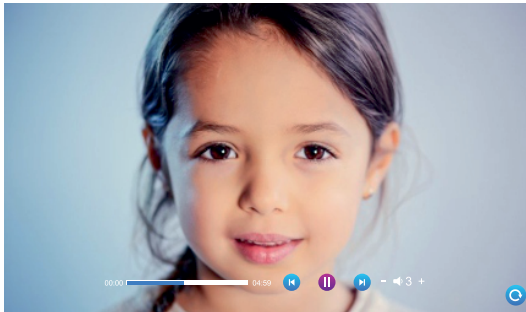

In the media interface, click Movie and a list of movie files will appear on the monitor. While the movie is playing, users can drag the progress bar to move forward or backward. The volume range is from 0 to 10, the factory setting is 7.



1. When the call button on the outdoor cassette is pressed or an alarm is triggered, movie playback is interrupted and the camera image is displayed on the monitor screen.

2. If only one file is saved in the folder, it is played back continuously.

3.2. Music

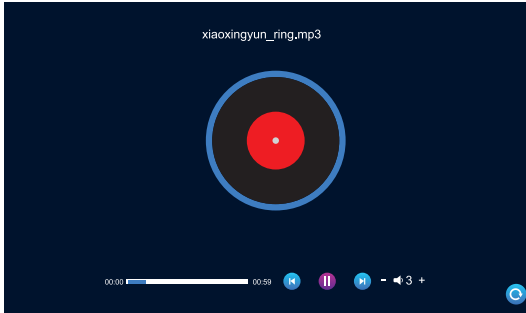

In the media interface, click Music to display the list of music files, and then click a music file to play it. In the playback interface, you can perform operations such as "previous song", "pause", "next song", "increase or decrease playback volume" and "back".

1. During music playback, drag the progress bar to fast-forward or rewind the file.
2. Set the volume from 1-10. The factory setting is 7.
3. For the MP3 music file to be found and played, place it in the "BgMusic" folder on the SD card.
4. If the call button on the outdoor panel is pressed or an alarm is triggered, music playback is interrupted and the camera image is displayed on the monitor screen.

3.3. Photo

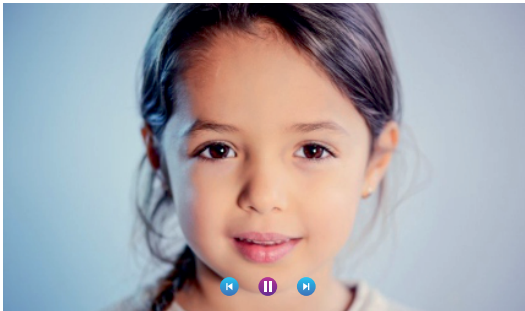

In the media interface, click Photos to view a list of photo files.

1. Photos are automatically displayed one after the other.
2. Photo must be placed in the "DigitalFrame" folder on the SD card to be displayed.

3.4. Files

In the media interface, click Files to view the SD card folders. Access the SD card to see the automatically created folder. The folders created automatically are: "DigitalFrame", "BgMusic", "Ring", "MessageImport" and "DOORBELL" (this folder is hidden in the internal monitor and can only be seen when the SD card is connected to the computer).

Digital frame - save images to be displayed in a digital frame.

BgMusic - save mp3 files to be played as background music.

Ring - save files to be selected as ring tones.

MessageImport - save the file to be played as an "answering machine".

Save the recorded voice file in this folder. In the file manager, find and click this file, then automatically import it into flash memory to replace the default message alert sound.

The voice file must be saved in mp3 format, with a maximum file size of 2MB.

Alarm - save files to be selected as alarm sounds.

Call - history of incoming calls.

MD - history of recorded motion detection.

MSG - history of recorded messages.

All records from above four folders are visible in event menu.

4. Event

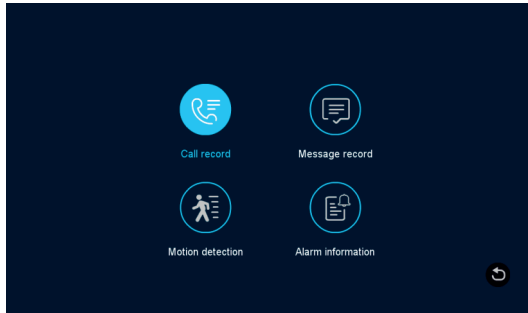

In the log you can check respectively: Call record, Message record, Motion detect and Alarm information.

Call record - a photo or video taken automatically or manually after a call from any outdoor panel.

Message record - message video is automatically recorded from the start of the call when the call is not answered by the user.

Motion detect - photo or video taken automatically or manually upon detection of movement from any outdoor panel or camera.

Alarm information - photo or video taken automatically or manually when an alarm is triggered from any camera.

Note: Once a file is selected, a long press on the button will bring up options to open, delete the selected file, delete all files, and close. In the record list, click the previous or next page to move on.

5. At home

1. At home - standard operating mode.
2. Not at home - the guest listens to the request to leave a message immediately after the call is established.
3. Do not disturb - in the normal operating mode, no ringing sound is emitted during the call.

6. Unlock/lock

Open the lock connecting to the indoor unit.

7. Standby

Switch to standby mode.

PICTURE PARAMETER SETTING

Once the connection to the outdoor panel has been established, the picture settings on the indoor monitor must be selected. The picture settings parameters are: call volume, brightness, contrast and saturation.

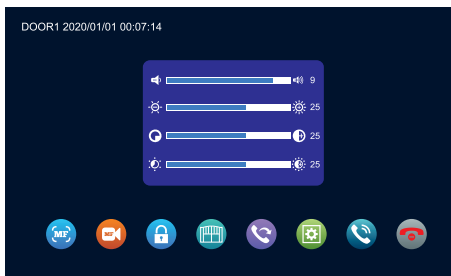

Intercom volume - adjustable from 0-10, the factory setting is 7.

Brightness - adjustable from 0-50, factory setting is 25.

Contrast - adjustable from 0-50, factory setting is 25.

Saturation - adjustable from 0-50, the factory setting is 25.

ALARM INSTRUCTIONS

The terminal and the GND contact are short-circuited, the alarm is activated, a ringing tone is emitted from the internal monitor speaker. To turn off the alarm and return to standby mode, press **⏻** during the alarm.

For models with an SD card, when the alarm sounds, the device automatically starts recording in video or photo mode (depending on the settings). The recording time is 120 seconds. To turn off the alarm and return to standby mode, press **⏻** during automatic recording.

If you have set a screenshot, when the alarm sounds, the device will automatically take a photo which will be displayed on the monitor screen for 120 seconds. To turn off the alarm and return to standby mode, press **⏻**.

Connection diagram:

1. Scheme is used for alarm with connection of two NC contacts or two NO contacts. 2 camera channels - no restrictions on the type of alarm contacts (can be NC or NO).
2. ALM contact of alarm sensor is connected in parallel with ALM contact (alarm sensor requires additional external power supply).
3. The GND contact of the sensor is connected in parallel with the GND contact of the camera.
4. In case of NO input, when GND and ALM are connected, alarm will go off.
5. In case of NC input, when GND and ALM are not connected, the alarm will go off.
6. This applies to any type of sensor.

INDOOR MONITOR INSTALLATION

Important:

- Do not install the device in the vicinity of other equipment that may be a source of strong radiation (TV, DVR, etc.).
- Do not disassemble the device yourself as this may cause a risk of electric shock.
- Do not drop, shake or strike the unit as this may damage the internal components.
- Choose the best vertical mounting height; the recommended height is 150cm.
- Turn off the power before mounting.
- To avoid potential interference, the mounting location must be min. 30cm from AC driven equipment.
- Avoid contact with water, magnetic fields and chemicals..

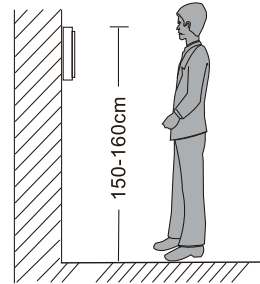

Pic. 37

Indoor monitor installation

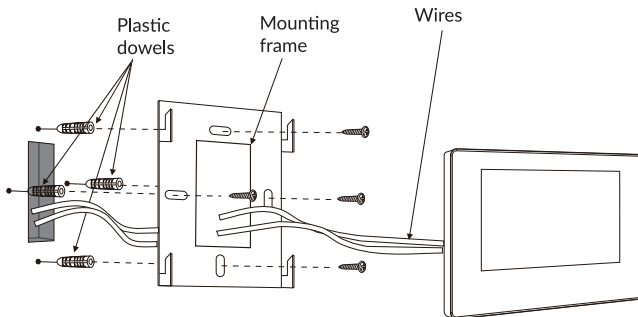

Rys. 38

MAINTENANCE

All maintenance operations should be carried out after disconnecting the power supply from the mains. The adapter does not require any special maintenance, however, in the case of considerable dust, vacuuming with compressed air is advisable.

ACCESSORIES (included)

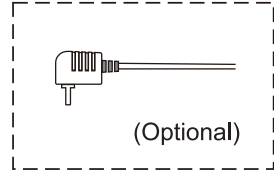
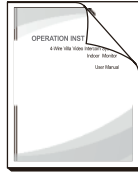
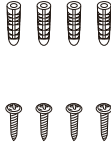
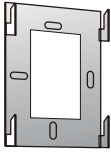
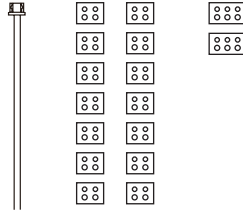
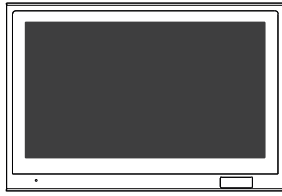

1. Indoor monitor - 1 pc
2. Plastic dowels - 4 pcs
3. Mounting screws - 4 pcs
4. Mounting frame - 1 pc
5. 4-pin/RJ45 cable - 1 pc
6. Two-row terminal block - 14 pc
7. Three-row terminal block - 2 pc
8. 2-pin cable - 1 pc
9. Operating manual - 1 pc
10. Power supply for DIN rail
11. Optional: AC adapter (not included)

ORNO-LOGISTIC Sp. z o.o.

ul. Rolników 437, 44-141 Gliwice tel. 32 43 43 110, www.virone.pl